

Solar Collector Dimensions (in inches)						
Model #	MS-21	MS-24	MS-26	MS-28	MS-32	MS-40
Length (in)	86.125	98.125	78.125	86.125	98.125	122.125
Width (in)	35.88	35.88	47.88	47.88	47.88	47.88
Height (in)	3.08	3.08	3.08	3.08	3.08	3.08
Gross Area (ft ²)	21.46	24.45	25.97	28.63	32.62	40.6
Dry Weight (lbs)	79	91	94	104	117	155
Fluid Capacity (gals)	0.7	0.76	0.9	0.96	1.05	1.22
Rec. Flow Rate (gpm)	0.7	0.8	0.8	0.9	1	1.2
Header Length (in)	38.5	38.5	50	50	50	50
Avg. BTU's/Day*	22,600	23,600	25,500	28,200	32,300	40,500
ICC-SRCC CERT #	10001956	10001957	10001958	10001959	10001960	10001961

*SRCC Category C Clear Day Performance

MS SERIES

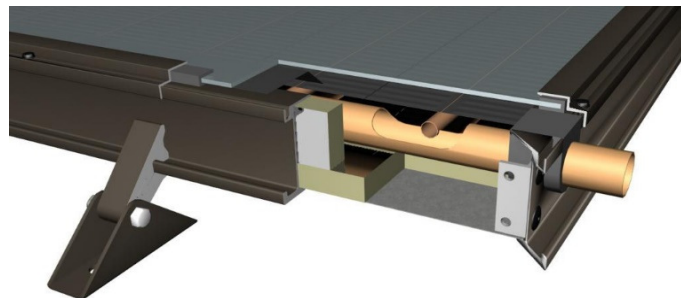

- Frame & Battens** Anodized 6063-T6 Aluminum, I Beam Style Frame
- Absorber** 100% Copper, Forge Welded, Crystal Clear Selective Coating by Thermafin
- Header Size** 1" Nominal Copper (1.125 OD) with 3/8" Nominal Risers (0.50" OD)
- Glazing** Low Iron, Tempered, "High-T"
- Gaskets/Grommets** EPDM UV durable U channel gasket. Extruded silicone grommet 1-1/8" bore
- Insulation** Polyisocyanurate closed cell insulation. Foid faced, rigid board.
- Mounts** Integral to frame - 3 options:

Universal Mounts



Flush Mounts



Rack Mounts

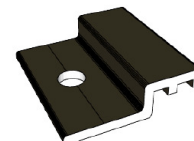

Alternate Energy Technologies, LLC

1345 Energy Cove Court, Green Cove Springs, FL 32043

Phone: 904-297-9369 x2 www.AETSolar.com sales@aetsolar.com