

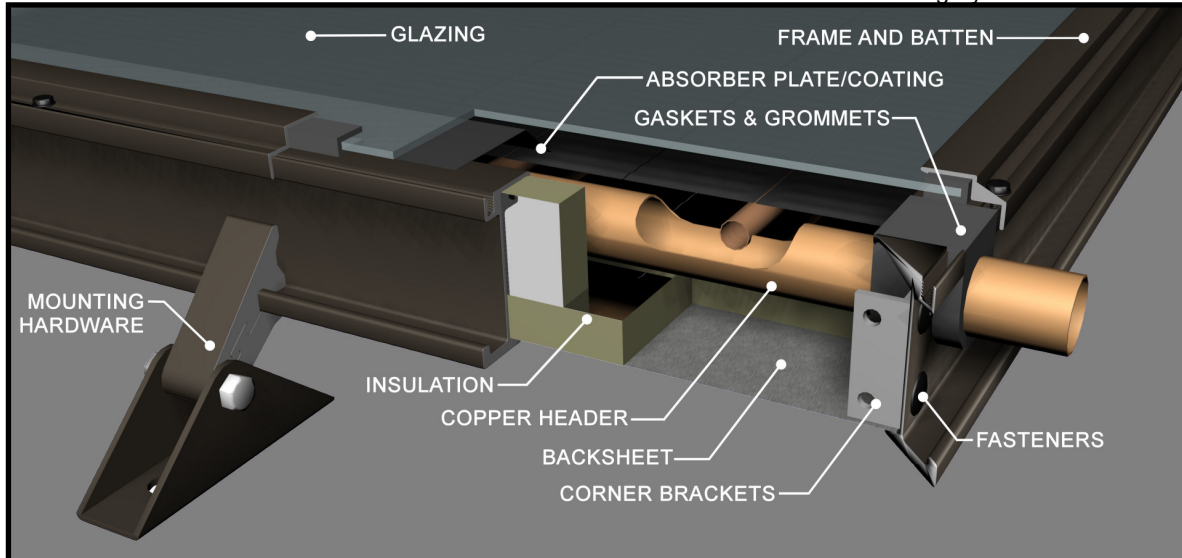

## **COLLECTOR SPECIFICATIONS**

<b>Collector:</b> MS-32	<b>Length:</b> 98.125 in.	<b>Width:</b> 47.875 in.
<b>Height:</b> 3.125 in.	<b>Gross Area:</b> 32.62 ft <sup>2</sup>	<b>Transparent Area:</b> 29.60 ft <sup>2</sup>
<b>Header Size:</b> 1"	<b>Header Length:</b> 50"	<b>Fluid Capacity:</b> 1.05 gals.
<b>Dry Weight:</b> 116 lbs.	<b>Max. Oper. Temp. :</b> 350 °F	<b>Avg BTU's/Day:</b> 32,300*
<b>Rec. Flow Rate:</b> 1.25 gpm	<b>Warranty:</b> 10 Years	<b>Design Life:</b> 30 Years

\*SRCC Category C



### **Collector Frame and Battens:**

Type 6063-T6 anodized extruded aluminum frame and battens.

### **Backsheet:**

Type 3105-h14, 0.019" stucco embossed aluminum sheet (bronze) pop-riveted to aluminum frame.

### **Corner Bracket:**

Architectural aluminum angles inside with aircraft-grade pin grip rivets to ensure high stability.

### **Insulation:**

Polyisocyanurate foam board insulation. Foil-faced, glass fiber-reinforced, rigid board Thermax sheathing 1-1/4" in the bed / 3/4" in the sidewalls.

### **Absorber Plate:**

Manufactured by Thermafin™ Mfg., a 100% copper absorber plate, high-frequency forge welded to create a crystalline homogeneous connection between the fin and riser tube.

### **Absorber Coating:**

Exclusively by Thermafin™ Manufacturing Selective Crystal Clear Coating  
 $\alpha \approx 0.96$   $\epsilon \approx 0.08$

### **Glazing:**

Low-Iron Tempered Glass exclusively using our new "High-T" tempered glass with a total solar energy transmission of 90%.

### **Gaskets & Grommets:**

A UV durable EPDM, U-channel gasket with molded corners which prohibits water penetration and assures long life. Extruded Silicone Grommet, 1-1/8" Bore.

### **Fasteners:**

5056 Aluminum Rivets secure the backsheet. Batten screws are 18-8 SS, 10-24 x 3/8", hex head screws, black oxide coated.

### **Mounting Hardware:**

The "Quick Lock" mounting design reduces mounting time. All mounting hardware integrates with frame extrusion and is tested to 102 PSF with safety factor of two.